

NOTES, UNLESS OTHERWISE SPECIFIED:

1. ALL DIMENSIONS ARE NOMINAL AND SHOWN FOR REFERENCE.
2. HOUSING & POPPET MATERIAL; TITANIUM, GRADE 5 (6AL-4V).
3. FINISH: TIODIZE.
4. SPOTFACE INDICATED TO HAVE A 32 MICRINCH FINISH WITH NO SWIRLMARKS.
5. CRACKING PRESSURE (FACTORY SET) 23 +/-3 PSI.
6. TORQUE TO 50-75 INCH-LBS.

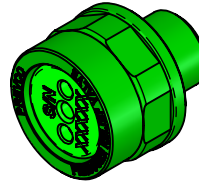

| REVISIONS |   |            |      |
|-----------|---|------------|------|
| REV.      | DESCRIPTION   | DATE       | APP. |
| A         | INITIAL RELEASE   | 7/9/13     | JAN  |
| B         | CORRECTED ASSY PART NUMBER, TORQUE RQMT & UPGRADED TO MOD 3 CONFIGURATION | 8/15/13    | JAN  |
| C         | ADDED "MARK BOTH HOLES WHITE"   | 9/22/14    | JAN  |
| D         | ADDED .547 MIN, $\phi$ .300 MIN WAS $\phi$ .187                           | 10/3/2016  | BD   |
| E         | UPDATED VIEWS FOR MOD 5   | 11/15/2017 | BD   |

PREVCO DUAL SEAL  
PRESSURE RELIEF  
VALVE (02081-001)

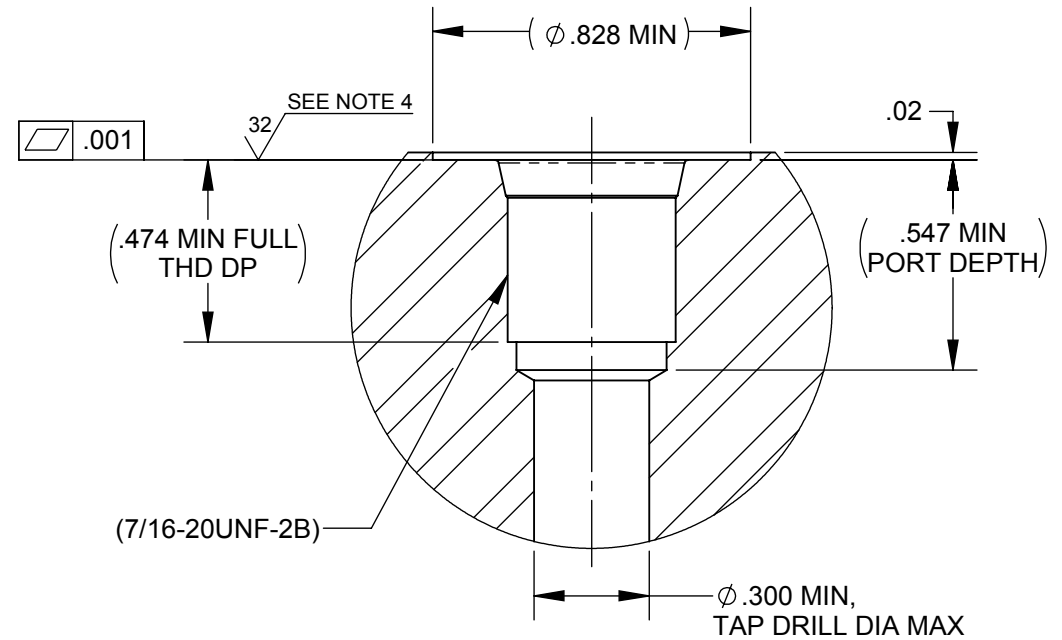
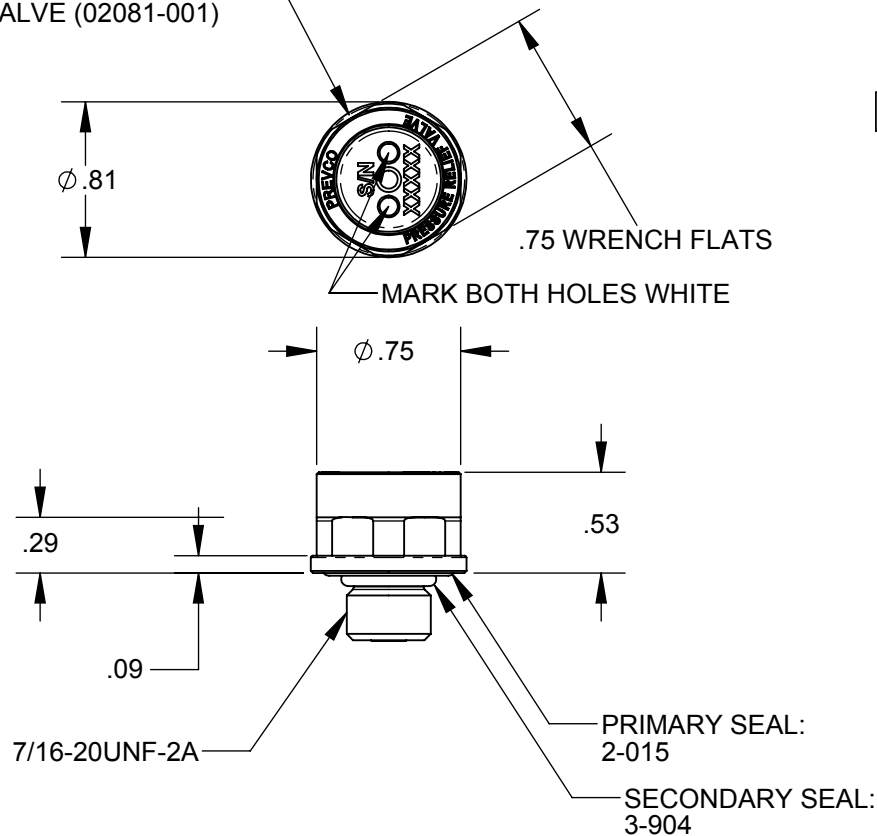

**DETAIL B - MOUNTING INTERFACE**  
**STANDARD SAE #4 PORT PER SAE J1926**  
**MODIFIED AS NOTED ABOVE**  
**USE PARKER TOOL #Y34732**

**PROPRIETARY NOTE**  
All data and information contained or disclosed by this document is confidential and proprietary information of **PREVCO Subsea LLC** and all rights therein are expressly reserved. By accepting this material the recipient agrees that the material and the information therein is held in confidence and in trust and will not be used, copied, reproduced in whole or in part, nor its content revealed in any manner to others, except to meet the specific purpose for which it was delivered.

| TOLERANCES UNLESS NOTED  |            |            |           |
|--------------------------|------------|------------|-----------|
| .X                       | .XX        | .XXX       | ANGLES    |
| $\pm$ .050               | $\pm$ .010 | $\pm$ .003 | $\pm$ .5° |
| CONCENTRICITY .004 TIR   |            |            |           |
| PRIMARY UNITS ARE INCHES |            |            |           |

| <b>PREVCO SUBSEA LLC</b> |                           |
|--------------------------|---------------------------|
| PROJECT<br>GENERIC       | MODEL NO. PREFIX<br>MOD 5 |
| CAGE CODE: 1PV08         |                           |
| DRAWN BY: VCE            | APPR. BY: BD              |

|   |              |
|---|--------------|
| DRAWING TITLE<br>DUAL SEAL PRESSURE RELIEF VALVE, 20psi VARIANT - ICD |              |
| DRAWING NO.<br>02080-001  |              |
| DRAWN DATE: 5/23/11   | SHEET 1 of 1 |
|   | REV. E       |